

landscape concept master plan

Townhead Park, Singleton

DRAWING REGISTER

- 01 Site context + description
- 02 Site assessment
- 03 Current facilities + issues A
- 04 Current facilities + issues B
- 05 Draft masterplan requirements
- 06 Precedent images
- 07 Existing conditions
- 08 Revised landscape masterplan
- 09 Landscape key diagram
- 10 Iconic sculptural entry plan
- 11 Iconic sculptural entry images
- 12 Cafe + playground plan
- 13 Cafe + playground images
- 14 exhibition space & exhibition lawn
- 15 RV + Bus parking + open space plan
- 16 Open parkland images
- 17 Bike track plan
- 18 Bike track images



REVISION K



site context + description

Townhead Park, Singleton

01

INTRODUCTION

Townhead Park is located at the south-eastern entry to the town of Singleton. The park is currently classified as a local recreational park within Singleton's Open Space Network (Singleton Council Open Space and Recreation Needs Study Ross Planning, 2013).

With the completion of the Hunter Expressway, Singleton Council has realised that Townhead Park has the potential to be redeveloped as an important gateway to the town offering travellers the first opportunity of taking a significant break having left the Hunter Expressway. It is proposed that the park be redeveloped in a manner that complements the Singleton Visitor Information and Enterprise Centre that was completed in 2010 and so making better use of the park's strategic location.

This document undertakes a review of the current park and makes suggestions on how Council may effect improvements that better cater for the needs of tourists and other travellers.

TOWNHEAD PARK MAP

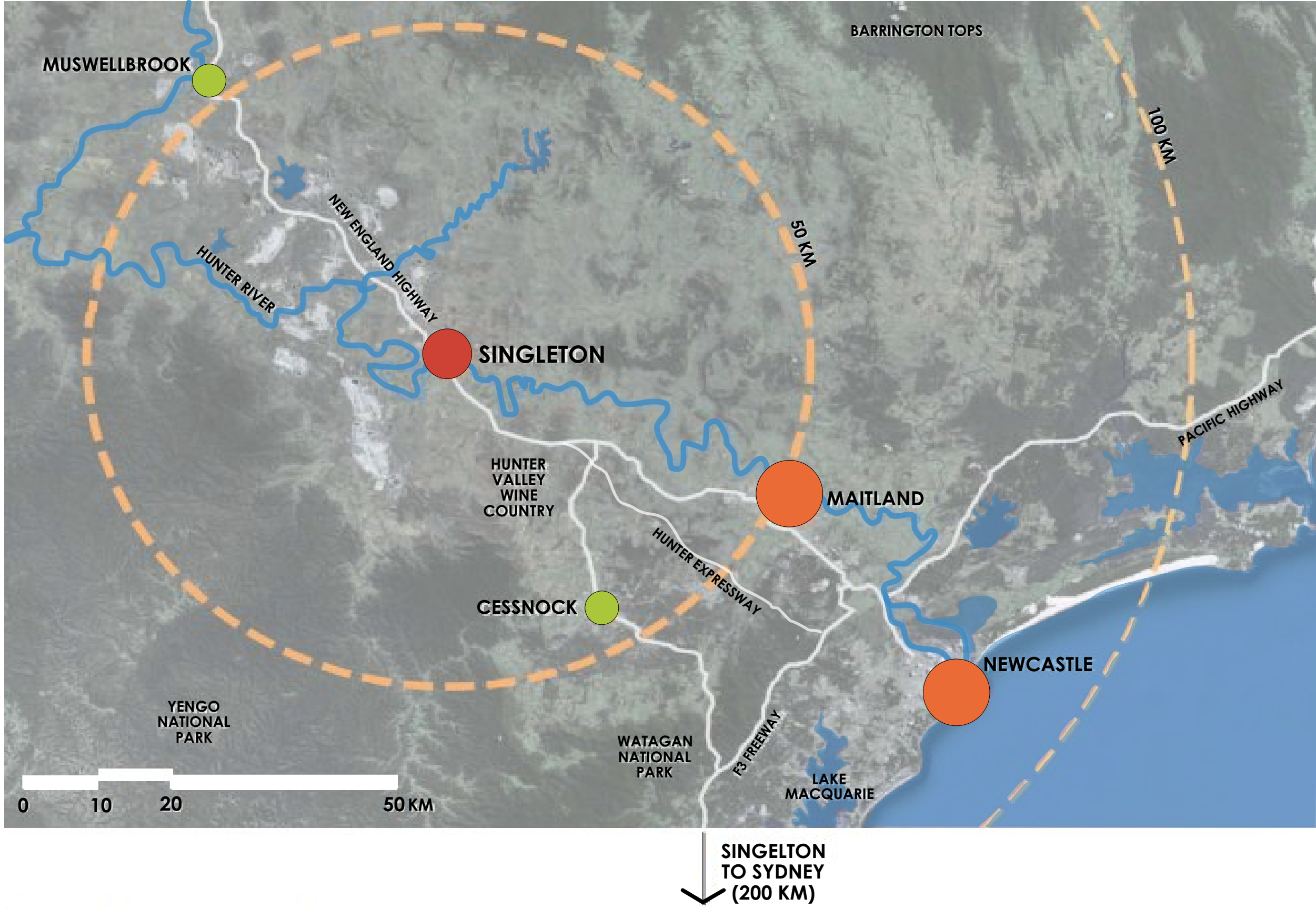

PROJECT:
LANDSCAPE CONCEPT MASTER PLAN
SITE:
TOWNHEAD PARK
SINGLTON, NSW 2330
CLIENT:
SINGLTON COUNCIL
DATE:
SEPTEMBER 2018
JOB NUMBER:
10459.5
DRAWN:
PMW + BJR + OJS
SCALE:
N/A
NO. IN SET:
01/18
REVISION:
K



site assessment

Townhead Park, Singleton

02



LEGEND

1. Singleton visitor & enterprise centre
2. Visitor car parking
3. External toilets
4. Picnic shelters with nearby BBQ
5. Sensory garden
6. Public art
7. Matilda Place (WWII Tank)
8. Children's playground
9. Cycle safely track
10. Attractive shade trees
11. Open space area
12. Tourist information board
13. Multiple signs



PROJECT:
LANDSCAPE CONCEPT MASTER PLAN
SITE:
TOWNHEAD PARK
SINGLETON, NSW 2330
CLIENT:
SINGLETON COUNCIL
DATE:
SEPTEMBER 2018
JOB NUMBER:
10459.5
DRAWN:
PMW + BJR + OJS
SCALE:
1:500 @ A1
NO. IN SET:
02/18
REVISION:
K



current facilities + issues

Townhead Park, Singleton

03

Singleton Visitor Information and Enterprise Centre (the Visitors' Centre) including tourist information, meeting rooms and small retail outlet specialising in souvenirs and locally-made products. There is provision for a cafe that is not used. Building has been raised to get above 1 in 100 year flood event.

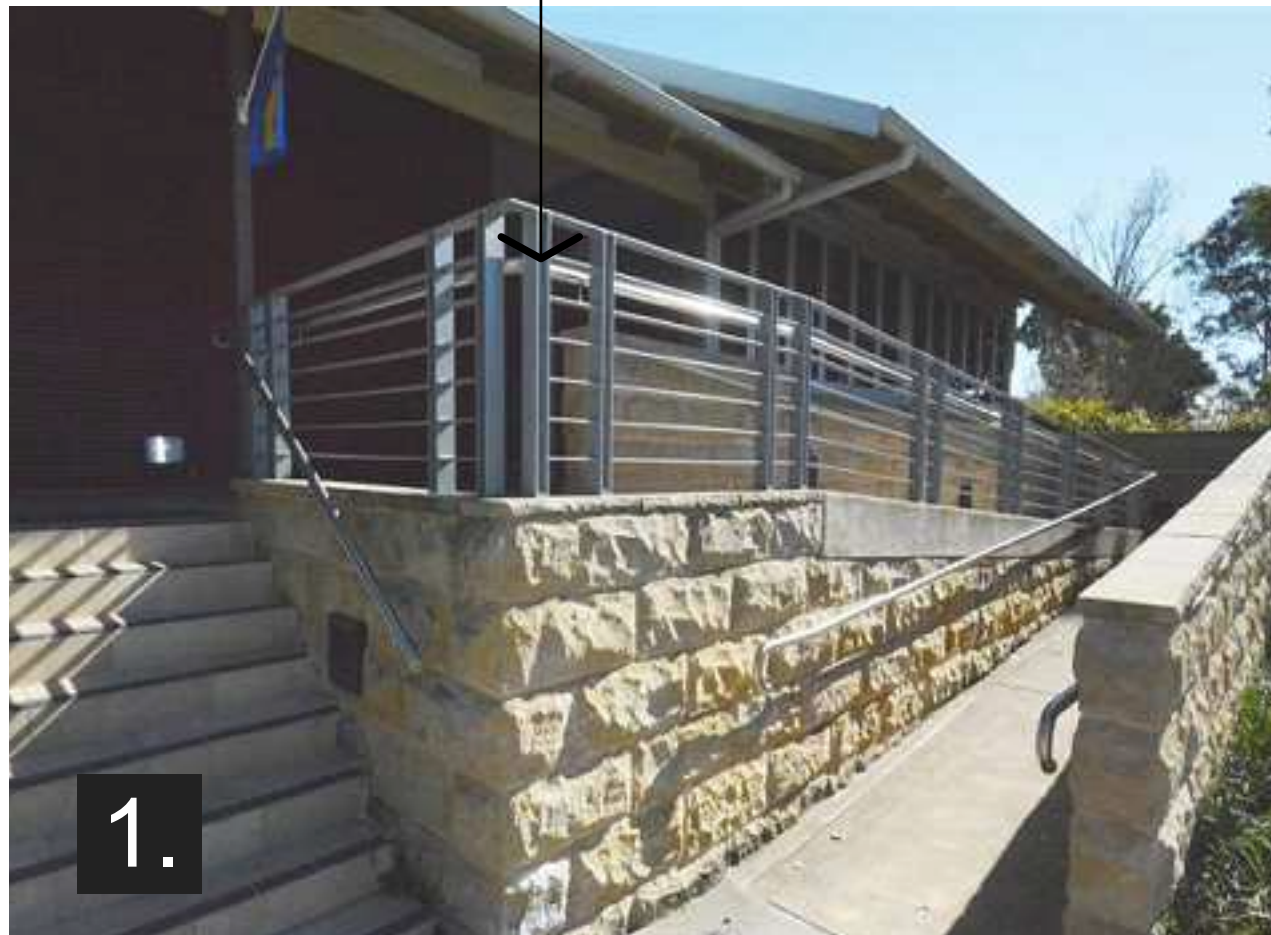

1.

Car parking for up to 37 cars and additional parking for oversized vehicles and trailers/caravans. Entry to the car park is not well presented to vehicles travelling along the New England Highway as it occurs at the end of planted gardens. Minor flooding occurs during heavy rain events that can result in reduced sections of the car park becoming inundated.



2.

Toilets both free standing and internal to the Visitors' Centre. Council is wishing to remove the free-standing facility as it has been replaced by those located at the Visitors' Centre.



3.



4.

Picnic shelters and gas barbecues. Still in good condition and placed in close proximity to the car park. Gas barbecues in well-sited in relation to shade structures.



5.

Sensory garden contained within an structure that has historic associations to *Temple Court* which served as Singleton's first hospital (1862) and roof trusses from the retort building from the Singleton Gas Company (1879). (Heritage Significance is limited.) The gardens are not well-maintained in terms of providing a sensory experience with some plants being unsuitable (e.g. *Trachelospermum jasminoides* having a low toxicity if ingested.)



6.

Poor display of Emma Anna's "Imagine" and Tricia Flanagan's "River Sculpture". Sculptures placed in front lawn but not given an appropriate setting.

Matilda Place: a remnant WWII tank relocated from other sites in and around Singleton.



7.



8.

Children's playground located to the north-west of (or behind) the Visitor's Centre with possible surveillance issues and the inability for visitors to know of its existence due to being hidden behind behind the building.



PROJECT:
LANDSCAPE CONCEPT MASTER PLAN
SITE:
TOWNHEAD PARK
SINGLETON, NSW 2330
CLIENT:
SINGLETON COUNCIL
DATE:
SEPTEMBER 2018
JOB NUMBER:
10459.5
DRAWN:
PMW + BJR + OJS
SCALE:
N/A
NO. IN SET:
03/18
REVISION:
K



current facilities + issues

Townhead Park, Singleton

04

Children's Safety Cycle Track takes up a large portion of the site near to the Visitor's Centre. Although a good facility, it may not be appropriate for a park servicing travellers and visitor to the area.



9.

The park has a range of large and distinctive trees that improve the parks amenity by offering shade and an attractive setting.



10.

A large area of undifferentiated open space occurs at the northern end of the park that is little used and has the potential to accommodate additional facilities.



11.



12.

Information Board has now become obsolete as it has been replaced by touch-screen technology located at the Visitors' Centre which can provide more information that is readily updated.



13.

There is a high prevalence of signs located along the frontage of the site, both regulatory and informative, which is confusing and counter-productive.



PROJECT:
LANDSCAPE CONCEPT MASTER PLAN
SITE:
TOWNHEAD PARK
SINGLETON, NSW 2330
CLIENT:
SINGLETON COUNCIL
DATE:
SEPTEMBER 2018
JOB NUMBER:
10459.5
DRAWN:
PMW + BJR + OJS
SCALE:
N/A
NO. IN SET:
04/18
REVISION:
K



draft master plan requirements

Townhead Park, Singleton

05



PREFERRED OUTCOMES

The overall aim of the development of Townhead Park is to create a destination for travellers by providing them a range of facilities and features that encourages motorists to take a break to reduce driver fatigue and to be made aware of the attractions that are available within the Singleton area. Council is wishing for the park to be seen as part of the town entry and so for this reason the site has been extended to include a section of the approach road.

The following are options being considered for the park:

- Improved approaches to the park extending from the intersection of the New England Highway and Kelso Street.
- Improved entry with easy recognition from further away. This may involve the inclusion of turning bays subject to consultation with the RMS.
- A reduction and co-ordination of signage located at the front of the park.
- Improved visual access to the Visitors' Centre and other facilities from the New England Highway.
- Improved parking and access including bus and caravan parking.
- Construction of a new exhibition space linked to the Visitors' Centre with the possibility of incorporating a sculpture park re-using existing public art and augmenting it with the work of local artists.
- Development of the cafe including expanded external seating with visibility to the New England Highway.
- Custom-designed shade structures and seating associated with electric barbecues and hot and cold water linked to solar cells.
- New play equipment catering for various age ranges for travellers with young children, with the possibility of incorporating water play and interactive, intelligent play equipment.
- An informal, kick-a-round area which may also double as a public gathering space. (eg. markets)
- Provision of a fenced, pet-friendly exercise area.
- Relocation of Matilda Tank.
- Attractive gardens and amenity planting generally having regard to CPTED requirements.
- Retention and management of existing significant trees.



PROJECT:
LANDSCAPE CONCEPT MASTER PLAN
SITE:
TOWNHEAD PARK
SINGLETON, NSW 2330
CLIENT:
SINGLETON COUNCIL
DATE:
SEPTEMBER 2018
JOB NUMBER:
10459.5
DRAWN:
PMW + BJR + OJS
SCALE:
1:500 @ A1
NO. IN SET:
05/18
REVISION:
K



precedent images

Townhead Park, Singleton

06

Children's playground and shade structures within a parkland setting.



1.

Informal/ movable seating as part of the proposed cafe, to encourage use of the open space adjacent to the cafe on clear spring days.



4.

Water wise gardens that re-use + create a feature with seasonal flooding.



2.



3.

high quality and contemporary design for the playground and surrounds will provide continuity with the artspace and sculpture lawn design.



5.

Sculpture park zone that could link to the proposed art gallery extension off the rear of the visitor centre.



PROJECT:
LANDSCAPE CONCEPT MASTER PLAN
SITE:
TOWNHEAD PARK
SINGLETON, NSW 2330
CLIENT:
SINGLETON COUNCIL
DATE:
SEPTEMBER 2018
JOB NUMBER:
10459.5
DRAWN:
PMW + BJR + OJS
SCALE:
N/A
NO. IN SET:
06/18
REVISION:
K

LEGEND

1. Ruffey Lake Park- Victoria
2. Springfield Town Centre Parklands - Ipswich
3. Lachlan's Line - North Ryde
4. Darling Quarter - Sydney
5. Birrarung Marr - Melbourne

existing conditions

Townhead Park, Singleton

07

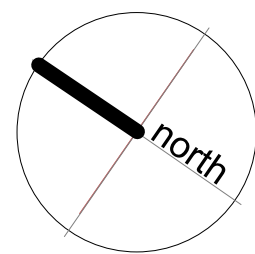

- LEGEND**
- Existing London Plane trees
 - Existing native trees
 - Existing Hills Fig
 - Proposed Hills Figs
 - Proposed deciduous trees
 - Proposed small native trees
 - Pathways
 - Turf areas
 - Mass planting areas
 - Play zones
 - Decking
 - Roadways
 - Park shelters and Barbeques
 - Accessible parking space
 - Electric Vehicle Charging Station



PROJECT:
LANDSCAPE CONCEPT MASTER PLAN
SITE:
TOWNHEAD PARK
SINGLETON, NSW 2330
CLIENT:
SINGLETON COUNCIL
DATE:
SEPTEMBER 2018
JOB NUMBER:
10459.5
DRAWN:
PMW + BJR + OJS
SCALE:
1:400 @ A1
NO. IN SET:
07/18
REVISION:
K

SCALE 1:400 0. 5. 20. 40. 80.



landscape master plan

Townhead Park, Singleton

08

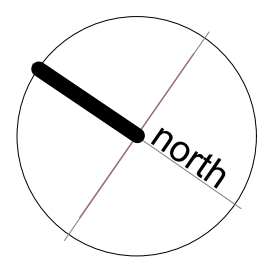

- 1 INSTALL PUBLIC ART TO DISPLAY LAWN.
- 2 CONSTRUCT EXHIBITION SPACE AND ASSOCIATED EXHIBITION LAWN.
- 3 PROVIDE PATH AND DELIVERY ACCESS LINKING TOWNHEAD CRESCENT TO DELIVERY AREA.
- 4 CREATE NEW BIKE TRACK.
- 5 REFRESHED SENSORY GARDEN.
- 6 PROVIDE ADDITIONAL PARKING OFF WATERHOUSE DRIVE (SUBJECT TO DEMAND).

LEGEND

- Existing London Plane trees
- Existing native trees
- Existing Hills Fig
- Proposed Hills Figs
- Proposed deciduous trees
- Proposed small native trees
- Pathways
- Turf areas
- Mass planting areas
- Play zones
- Decking
- Roadways
- Park shelters and Barbeques
- Accessible parking space
- Electric Vehicle Charging Station



PROJECT:
LANDSCAPE CONCEPT MASTER PLAN
SITE:
TOWNHEAD PARK
SINGLETON, NSW 2330
CLIENT:
SINGLETON COUNCIL
DATE:
SEPTEMBER 2018
JOB NUMBER:
10459.5
DRAWN:
PMW + BJR + OJS
SCALE:
1:400 @ A1
NO. IN SET:
08/18
REVISION:
K



landscape key diagram

Townhead Park, Singleton

09

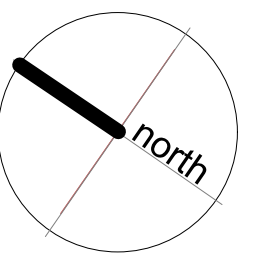

LEGEND

- Existing London Plane trees
- Existing native trees
- Existing Hills Fig
- Proposed Hills Figs
- Proposed deciduous trees
- Proposed small native trees
- Pathways
- Turf areas
- Mass planting areas
- Play zones
- Decking
- Roadways
- Park shelters and Barbeques
- Accessible parking space
- Electric Vehicle Charging Station



PROJECT:
LANDSCAPE CONCEPT MASTER PLAN
SITE:
TOWNHEAD PARK
SINGLETON, NSW 2330
CLIENT:
SINGLETON COUNCIL
DATE:
SEPTEMBER 2018
JOB NUMBER:
10459.5
DRAWN:
PMW + BJR + OJS
SCALE:
1:500 @ A1
NO. IN SET:
09/18
REVISION:
K

SCALE 1:400 0. 5. 20. 40. 80.

iconic sculptural entry plan

Townhead Park, Singleton

10

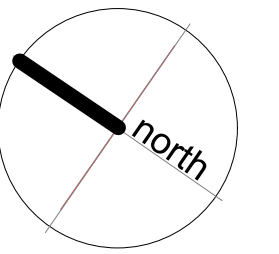

LEGEND

- Existing London Plane trees
- Existing native trees
- Existing Hills Fig
- Proposed Hills Figs
- Proposed deciduous trees
- Proposed small native trees
- Pathways
- Turf areas
- Mass planting areas
- Play zones
- Decking
- Roadways
- Park shelters and Barbeques
- Accessible parking space
- Electric Vehicle Charging Station



Turning lane off the New England Highway.

New low wall entry signage and gardens.

New locations for display poles.

Curved raised garden with mass planting. Sandstone log edging.

Large iconic sculptural element that becomes a symbol for Singleton. Refer to L11 for precedent images.

Existing mature London Plane tree [Platanus x acerifolia] To be retained and protected.

Extended carparking area for the visitor centre and adjoining parkland.

Picnic shelters to provide for tourists to rest and cook at BBQs amongst existing trees.



PROJECT:
LANDSCAPE CONCEPT MASTER PLAN
SITE:
TOWNHEAD PARK
SINGLETON, NSW 2330
CLIENT:
SINGLETON COUNCIL
DATE:
SEPTEMBER 2018
JOB NUMBER:
10459.5
DRAWN:
PMW + BJR + OJS
SCALE:
1:200 @ A1
NO. IN SET:
10/18
REVISION:
K



SCALE 1:200 0 5 10 20 40

iconic sculptural entry images

Townhead Park, Singleton

11



PROJECT:
LANDSCAPE CONCEPT MASTER PLAN
SITE:
TOWNHEAD PARK
SINGLETON, NSW 2330
CLIENT:
SINGLETON COUNCIL
DATE:
SEPTEMBER 2018
JOB NUMBER:
10459.5
DRAWN:
PMW + BJR + OJS
SCALE:
N/A
NO. IN SET:
11/18
REVISION:
K

LEGEND

1. Low entry walls upon entry, naming the park with groundcover mass planting around the base. Signage to be lit up at night.
2. Large sculpture with galloping horses over water feature pond as a reference to the areas horse racing industry.
3. Sculptural elements that refer to the wine region - Wine barrel metal rings.

It is proposed that the island lawn facing the New England Highway be used to provide an art piece/ town art that will be used to mark the site of the tourist park. If chosen wisely, it is possible for this sculpture to be used to take photos for use on social media as means of promoting singleton by visitors.

cafe + playground

Townhead Park, Singleton

12

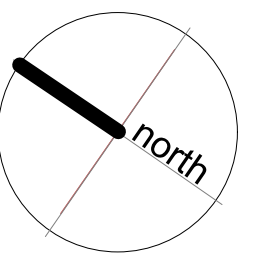

LEGEND

- Existing London Plane trees
- Existing native trees
- Existing Hills Fig
- Proposed Hills Figs
- Proposed deciduous trees
- Proposed small native trees
- Pathways
- Turf areas
- Mass planting areas
- Play zones
- Decking
- Roadways
- Park shelters and Barbeques
- Accessible parking space
- Electric Vehicle Charging Station



Existing large fig tree to be retained and protected.

New entry plaza that connects the existing entry of the tourist centre to new cafe, playground and new bike track.

Enhanced connections within the tourist centre to the proposed cafe.

Large outdoor terrace that is used by the cafe and connects the tourist centre to the outdoor exhibition lawn.

New children's adventure bike track set amongst existing trees.

New children's playground in a large soffall area under shade sails.



PROJECT:
LANDSCAPE CONCEPT MASTER PLAN
SITE:
TOWNHEAD PARK
SINGLETON, NSW 2330
CLIENT:
SINGLETON COUNCIL
DATE:
SEPTEMBER 2018
JOB NUMBER:
10459.5
DRAWN:
PMW + BJR + OJS
SCALE:
1:200 @ A1
NO. IN SET:
12/18
REVISION:
K



cafe + playground

Townhead Park, Singleton

13

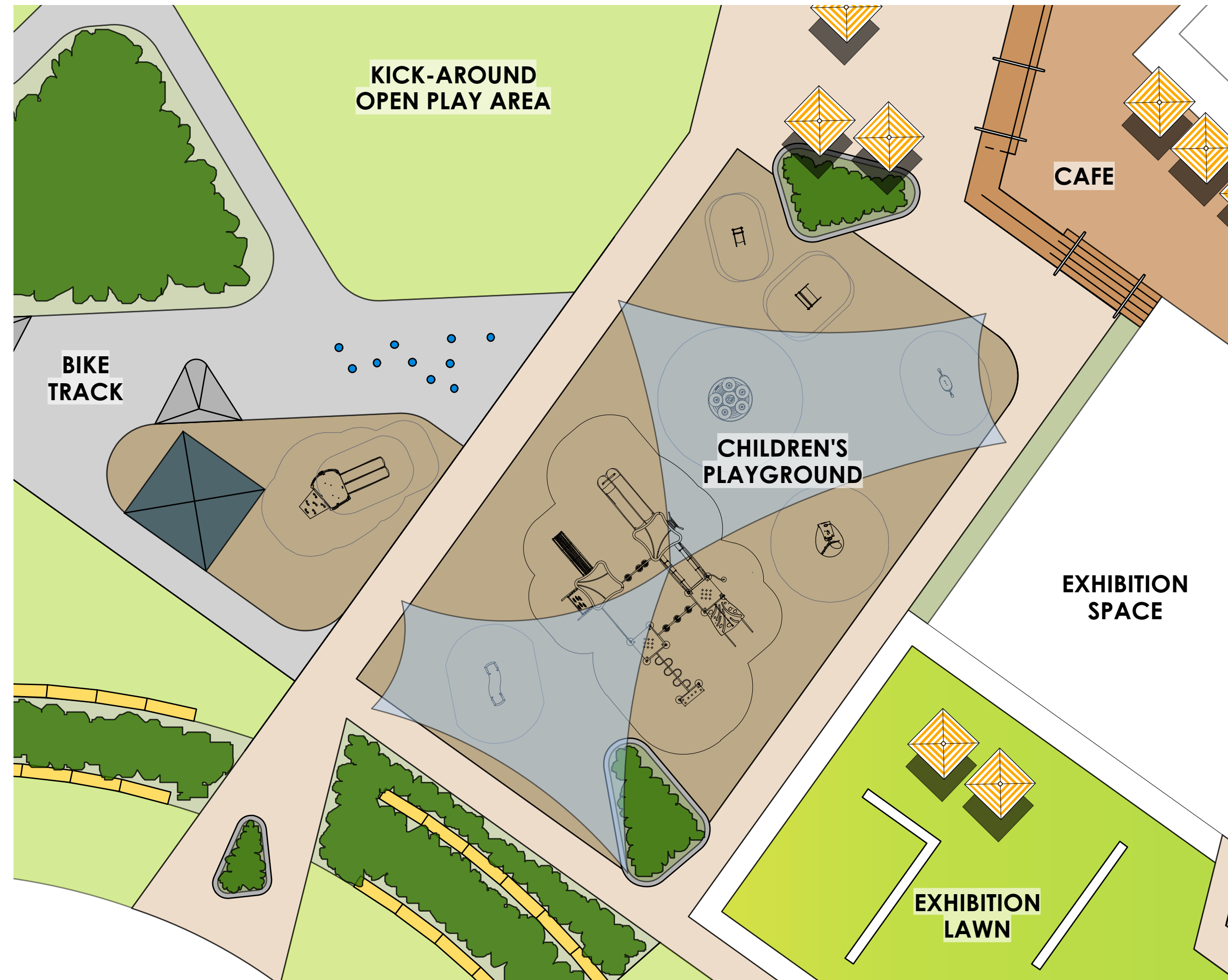

LEGEND

1. Cafe seating in a parkland setting (centennial park cafe).
2. Playground space opening onto informal kickaround area.
3. Indicative outdoor exhibition area showing artwork.

The terrace, cafe and playground areas link the exhibition lawn and informal lawns as a hub of activation and a blending of the material palette to provide continuity across the site.



PROJECT:
LANDSCAPE CONCEPT MASTER PLAN
SITE:
TOWNHEAD PARK
SINGLETON, NSW 2330
CLIENT:
SINGLETON COUNCIL
DATE:
SEPTEMBER 2018
JOB NUMBER:
10459.5
DRAWN:
PMW + BJR + OJS
SCALE:
1:150 @ A1
NO. IN SET:
13/18
REVISION:
K



exhibition space + exhibition lawn

Townhead Park, Singleton

14



LEGEND

1. Art & handmade markets.
2. Food & wine fair.
3. Historical & community events
4. Performance art
5. Outdoor cinema
6. Outdoor exhibitions
7. Rural displays
8. Live Music
9. Master classes/workshops
10. Sculptural exhibitions

This facility is intended to be a multi-purpose area allowing for changing displays and activities that highlight the key attributes of the Singleton area and its people. Its function is to offer attractions that contribute to the destination nature of the park and so encouraging travellers to stop, rest and be informed of local attractions. The lawn area is intended to augment the exhibition space offering the potential to extend the range of displays that can be provided. The main entry into the exhibition space will be via the visitor centre with the option of a secondary entry being provided from the park.



PROJECT:
LANDSCAPE CONCEPT MASTER PLAN
SITE:
TOWNHEAD PARK
SINGLETON, NSW 2330
CLIENT:
SINGLETON COUNCIL
DATE:
SEPTEMBER 2018
JOB NUMBER:
10459.5
DRAWN:
PMW + BJR + OJS
SCALE:
N/A
NO. IN SET:
14/18
REVISION:
K



RV + bus parking + open space

Townhead Park, Singleton

15

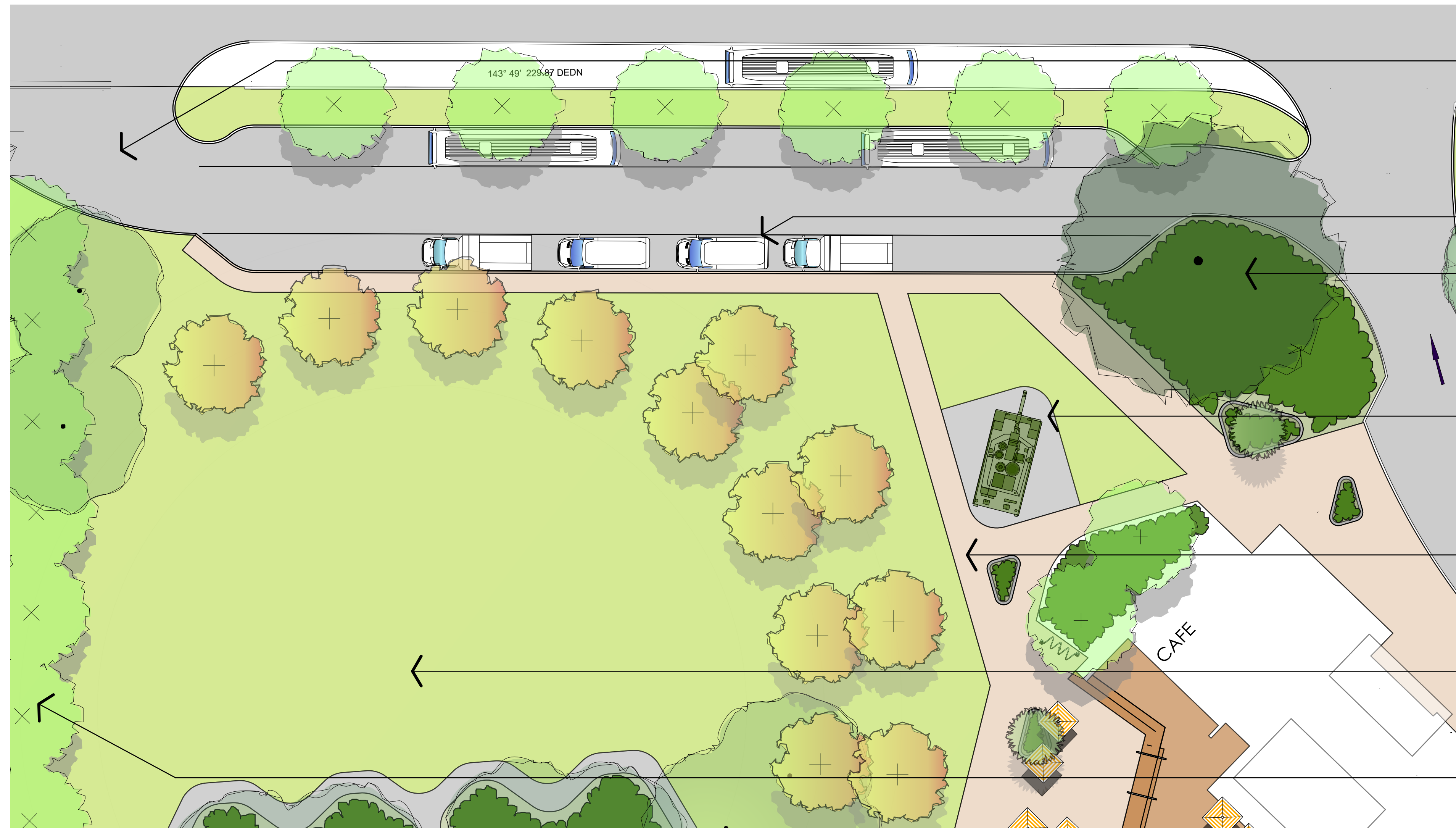
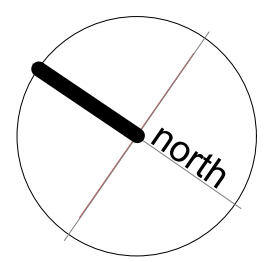

SCALE 1:200 0 5 10 20 40

LEGEND

- Existing London Plane trees
- Existing native trees
- Existing Hills Fig
- Proposed Hills Figs
- Proposed deciduous trees
- Proposed small native trees
- Pathways
- Turf areas
- Mass planting areas
- Play zones
- Decking
- Roadways
- Park shelters and Barbeques
- Accessible parking space
- Electric Vehicle Charging Station

Exit on to the New England Highway.

Bus and RV parking bays.

Existing fig tree to be retained.

'Matilda' the tank to be relocated to this position with associated signage and memorial plaques.

New pathway that wraps around the open parkland space and connects the RV and bus parking area to the cafe and playground.

Level open turf area to be an area for ball games and small events. Refer to precedent images on sheet L16.

Edge of trees planted around the perimeter of the open lawn area.



PROJECT:
LANDSCAPE CONCEPT MASTER PLAN
SITE:
TOWNHEAD PARK
SINGLETON, NSW 2330
CLIENT:
SINGLETON COUNCIL
DATE:
SEPTEMBER 2018
JOB NUMBER:
10459.5
DRAWN:
PMW + BJR + OJS
SCALE:
1:200 @ A1
NO. IN SET:
15/18
REVISION:
K



RV + bus parking + open space

Townhead Park, Singleton

16



LEGEND

1. Food trucks at a weekend market.
2. Outdoor yoga classes.
3. RV & camping shows.
4. Picnic and ball games on the open lawn area.
5. Christmas carols.
6. Local wine and cheese/farmers market stalls within the open lawn area.



PROJECT:
LANDSCAPE CONCEPT MASTER PLAN
SITE:
TOWNHEAD PARK
SINGLETON, NSW 2330
CLIENT:
SINGLETON COUNCIL
DATE:
SEPTEMBER 2018
JOB NUMBER:
10459.5
DRAWN:
PMW + BJR + OJS
SCALE:
N/A
NO. IN SET:
16/18
REVISION:
K



bike track plan

Townhead Park, Singleton

17

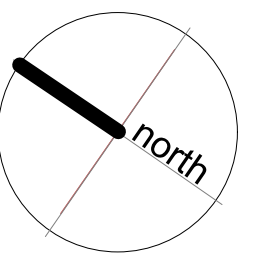

LEGEND

-  - Existing London Plane trees
-  - Existing native trees
-  - Existing Hills Fig
-  - Proposed Hills Figs
-  - Proposed deciduous trees
-  - Proposed small native trees
-  - Pathways
-  - Turf areas
-  - Mass planting areas
-  - Play zones
-  - Decking
-  - Roadways
-  - Park shelters and Barbeques
-  - Accessible parking space
-  - Electric Vehicle Charging Station



Triangular side ramps/
speed bumps for the more
adventurous bike rider.

Timber bridge and rough
brick path to give the bikes
different surfaces to ride on
and experience.

The perimeter of the playground
to be planted with shrubs and
trees to provide a green buffer
of screening along a residential
area.

Main entry into the active
playground. Zig zag line
represents new fencing.
Refer to L10.

Shade structure that sits between
both childrens playground and the
bike track.

Any existing trees within the area
are to be retained and protected.

Additional parking added
along Waterhouse Avenue.

Raised circular mound
roundabout.

SCALE 1:200 0 5 10 20 40



PROJECT:
LANDSCAPE CONCEPT MASTER PLAN
SITE:
TOWNHEAD PARK
SINGLETON, NSW 2330
CLIENT:
SINGLETON COUNCIL
DATE:
SEPTEMBER 2018
JOB NUMBER:
10459.5
DRAWN:
PMW + BJR + OJS
SCALE:
1:200 @ A1
NO. IN SET:
17/18
REVISION:
K



bike track images

Townhead Park, Singleton

18

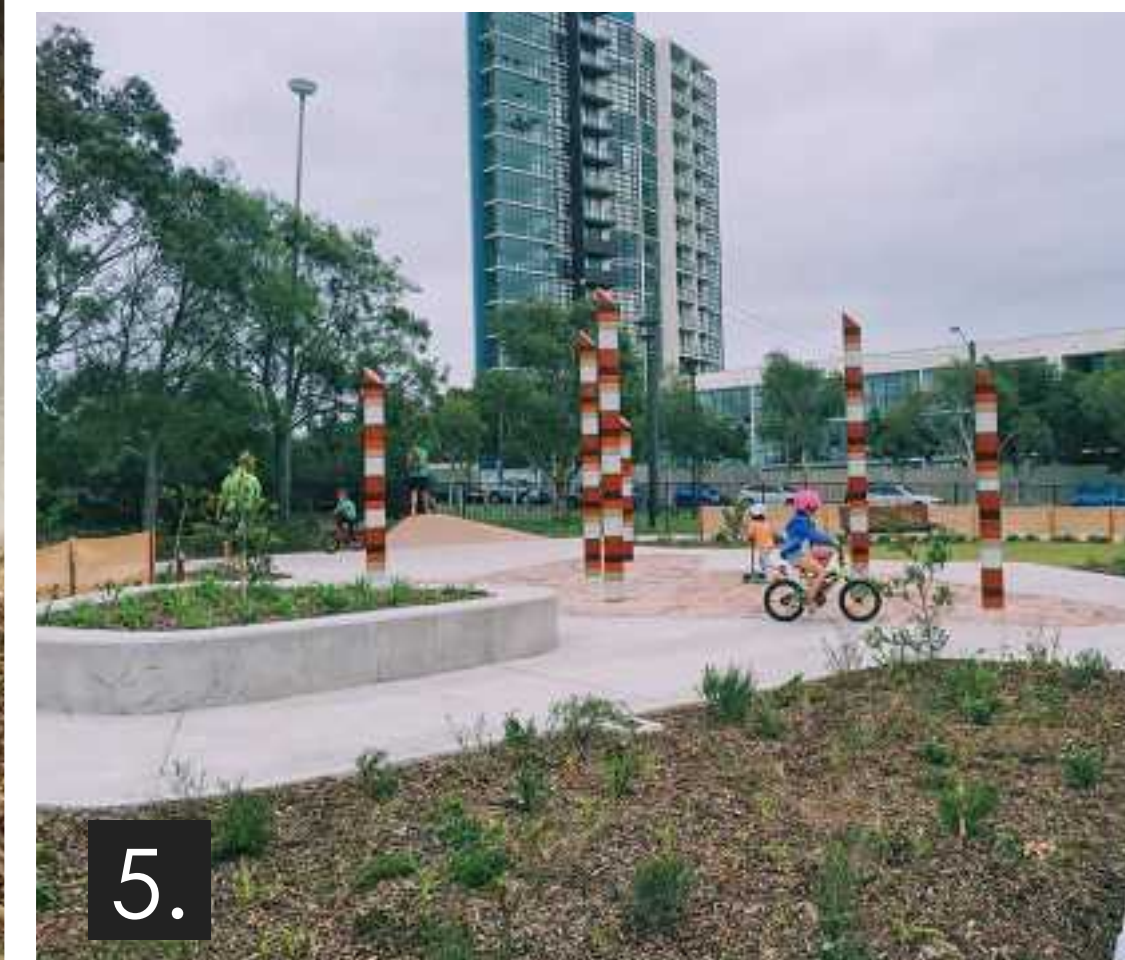

PROJECT:
LANDSCAPE CONCEPT MASTER PLAN
SITE:
TOWNHEAD PARK
SINGLETON, NSW 2330
CLIENT:
SINGLETON COUNCIL
DATE:
SEPTEMBER 2018
JOB NUMBER:
10459.5
DRAWN:
PMW + BJR + OJS
SCALE:
N/A
NO. IN SET:
18/18
REVISION:
K

LEGEND

1. Raised speed bumps/ ramps to provide an extra challenge.
2. Large ropes on stands to provide mock bike locking stations.
3. Bright traffic signals incorporated.
4. Artistic tunnel for kids to pass through.
5. Multiple timber totem obstacle course entry into the bike track.
6. A space for parents to have fun with their kids and be apart of the adventures.